

List of parts

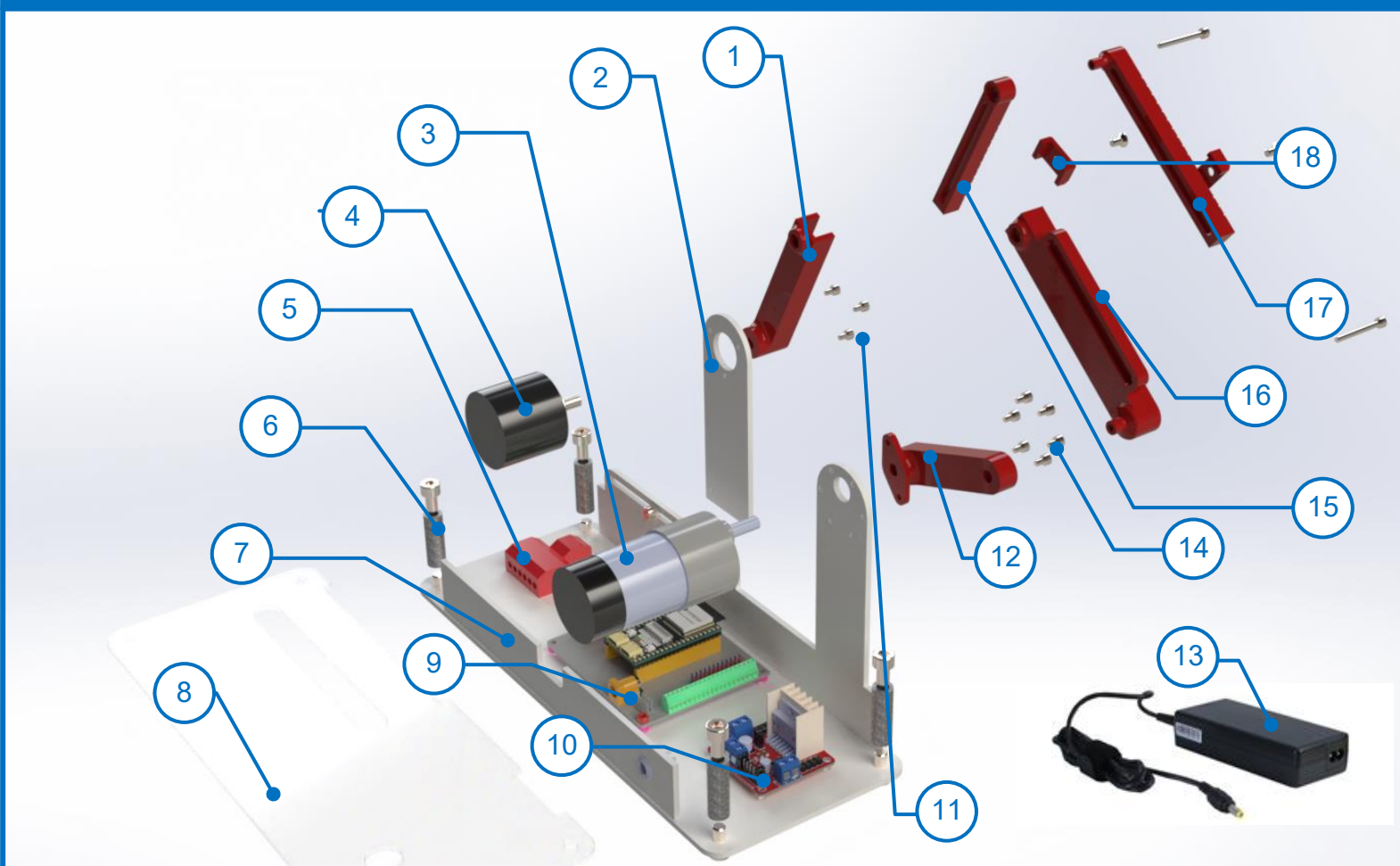

- | | | | |
|---|--------------------------|----|------------------------|
| 1 | Semi link 1A | 10 | Driver L298n |
| 2 | Encoder support | 11 | Encoder screws M3 (x3) |
| 3 | Motor | 12 | Link C |
| 4 | Encoder | 13 | Power supply 12V 5A |
| 5 | Electrical connection | 14 | Motor screws M3 (x6) |
| 6 | Sleeve and screw M6 (x4) | 15 | Semi link 2A |
| 7 | Frame | 16 | Semi link 1B |
| 8 | Cover | 17 | Semi link 2B |
| 9 | ESP32 GPIO | 18 | Clamp |

Estimated price: 95€

Tools

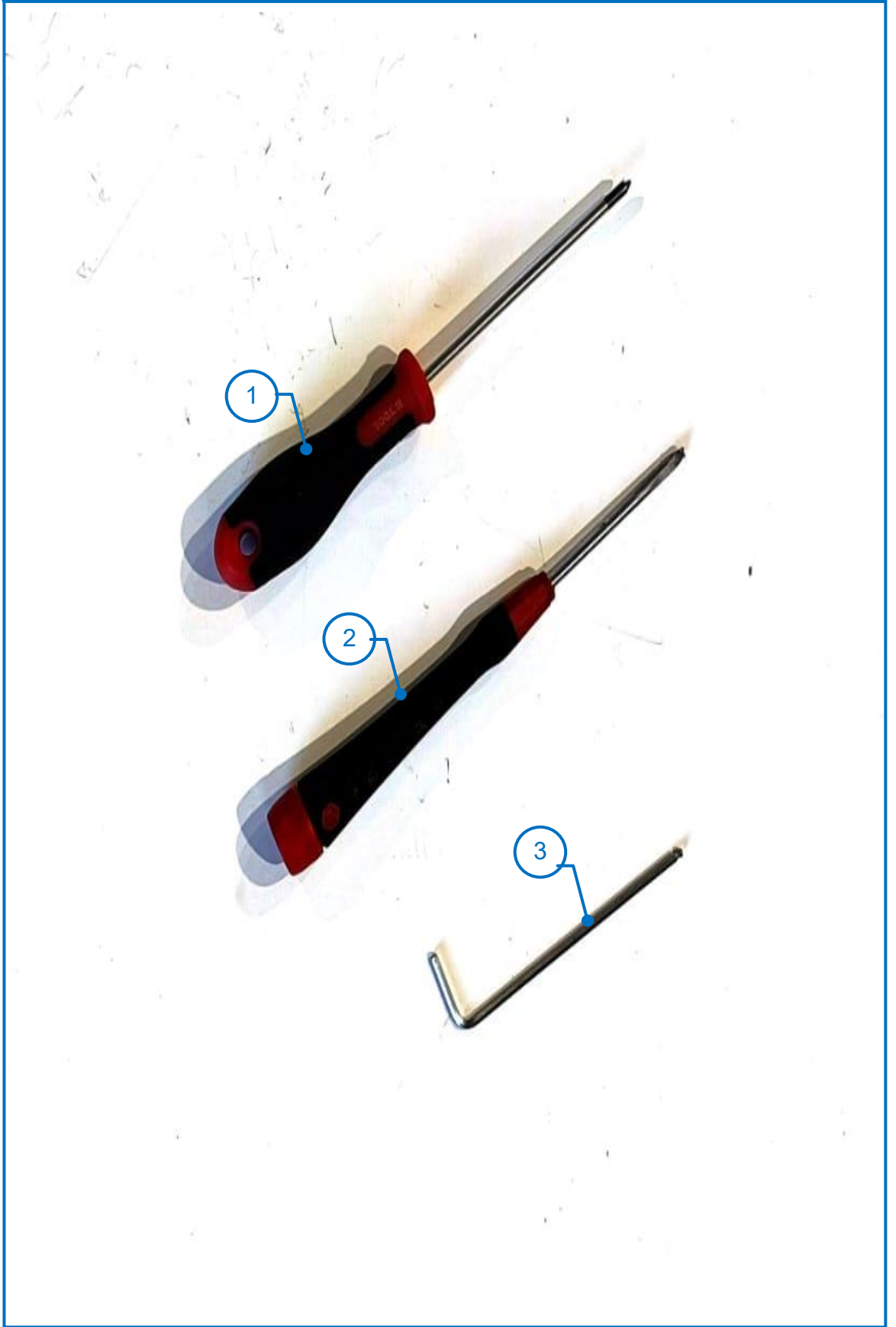

- | | |
|---|----------------------------|
| 1 | Small Phillips screwdriver |
| 2 | Small Flathead screwdriver |
| 3 | Hex key 2mm and 4mm |

Step 1: Assemble links



Using Hex key, fix the links



Step 2: Assemble encoder, motor and electronic devices

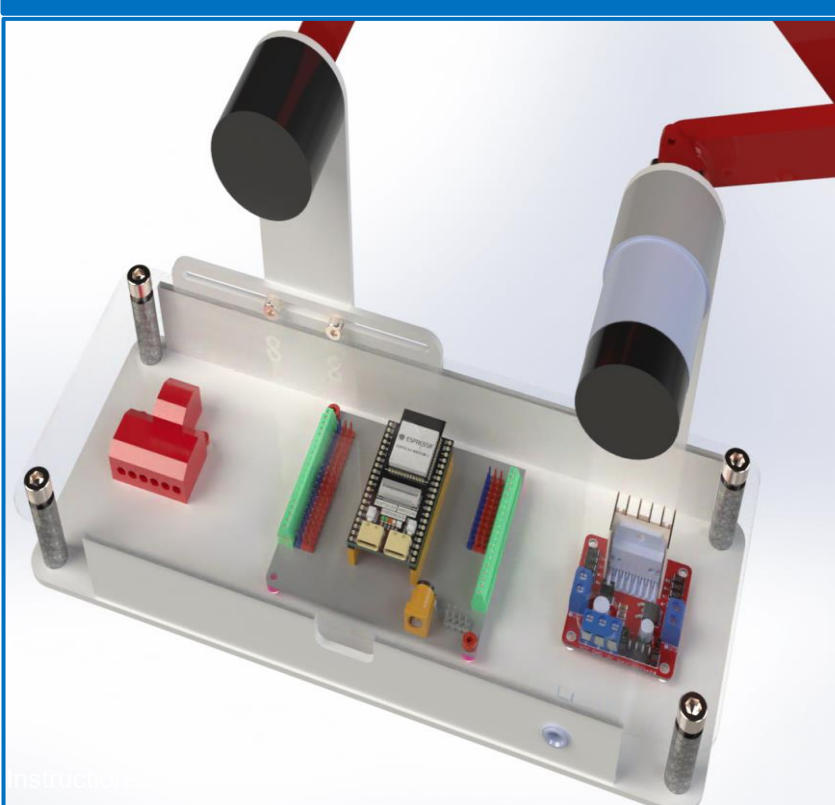

Fix the motor, encoder and electronic devices to the frame



Step 3: Electrical installation

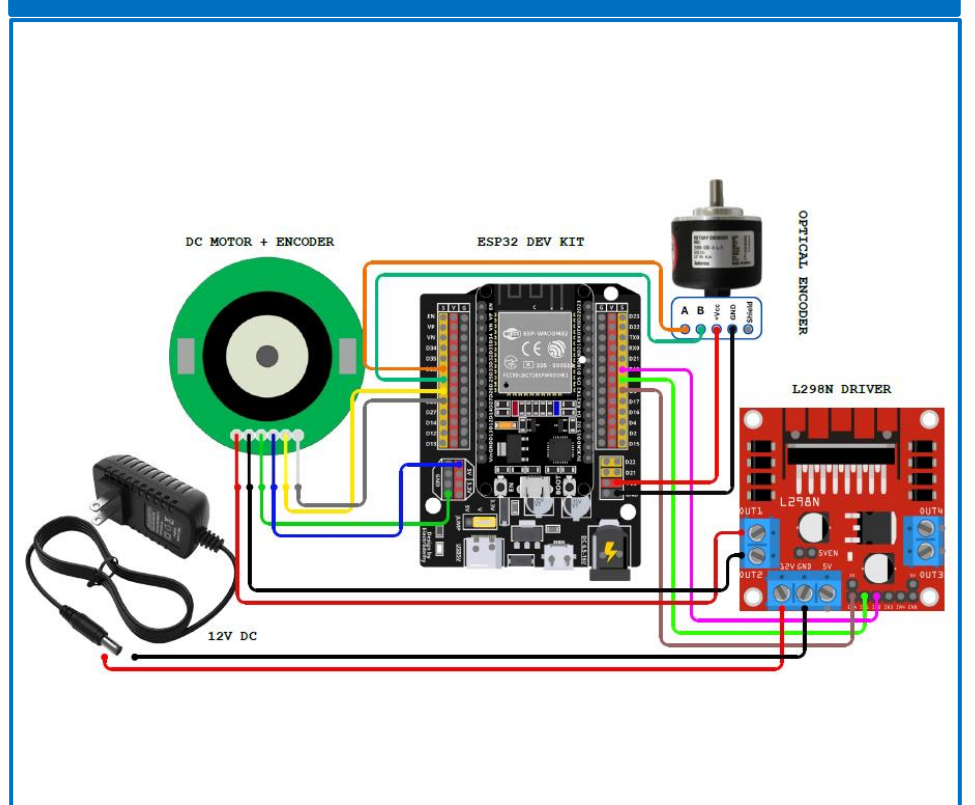

Connect the electronic devices as indicated in the diagram

